



Sherwood Avenue, Waldersalde, ME5

£350,000 in excess

Property Description

This home won't be around for long, in the ever popular Walderslade Village. The hallway leads to a lovely open lounge with feature fireplace and lots of space for the family to relax. The kitchen / dining room is situated across the back of the home overlooking the private rear garden. On the first floor there are three family sized bedrooms with a newly installed bathroom, this home is completed with a driveway and garage to the front of the home and a large private rear garden.

EPC Rating: E



Key Features

- ✓ Three Bedroom Semi Detached Home
- ✓ Well Presented Throughout
- ✓ Modern Fitted Bathroom
- ✓ School Catchment Area
- ✓ Sought After Location
- ✓ Garage & Driveway
- ✓ Large Private Rear Garden





All

Sherwood Avenue, Chatham, ME5

Approximate Area = 1025 sq ft / 95 sq m (includes garage)

For identification only - Not to scale

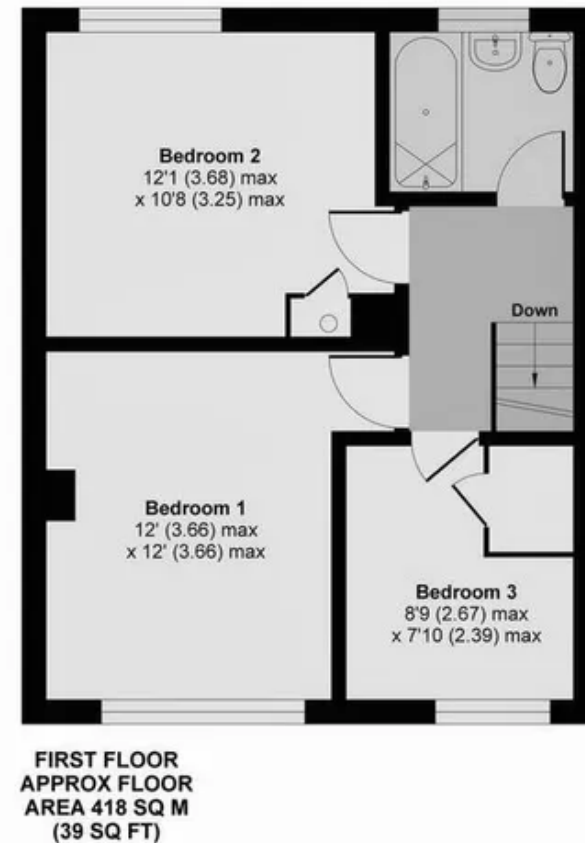

Freeman & Gray

01634 310339

info@freemanandgray.com

